

**SURFACE MOUNT POWER
INDUCTOR SERIES LPPI252008**

FEATURES

- Low profile
- High reliability and efficiency
- RoHS compliant plus Lead & Halogen free
- Magnetically shielded

ELECTRICAL SPECIFICATIONS

- Inductance range 0.47uH to 10.0uH
- Test frequency 1MHz with test level 0.1 V
- Test equipment Quadtech 1910 L analyzer
- Rated current range 0.41 to 2.20 Amps
- Tolerance ± 20% (M)
- Rated current Refer to notes below

PHYSICAL SPECIFICATIONS

- Operating temp. -40°C to +125°C
- Core Ferrite core
- Terminal construction Ag/Ni/Sn plating
- Packaging T & R 2000 pieces per reel
- Tape & reel spec. Tape 8 mm embossed carrier
Reel 178 mm reel

DIMENSIONS IN MILLIMETERS

- Length A 2.50-0.1/+0.3
- Width B 2.0-0.05/+0.35
- Height C 0.80 max.
- Terminal width D 0.85 ref.
- Terminal pitch E 0.80 ref.

RECOMMENDED PC BOARD PATTERN

- L = 2.7 mm ref.
- G = 0.8 mm ref.
- H = 2.2 mm ref.

SPECIFICATIONS

Part Number	L (μH)	Tol % ±	DCR ±20% (mΩ)	Rated Current (A)	
				I _{rms} ⁽¹⁾	I _{sat} ⁽²⁾
LPPI252008-R47M	0.47	20	80	1.25	2.20
LPPI252008-R68M	0.68	20	100	1.15	1.80
LPPI252008-1R0M	1.0	20	120	1.05	1.50
LPPI252008-1R5M	1.5	20	170	0.95	1.45
LPPI252008-2R2M	2.2	20	210	0.85	1.20
LPPI252008-3R3M	3.3	20	300	0.75	0.95
LPPI252008-4R7M	4.7	20	400	0.63	0.80
LPPI252008-6R8M	6.8	20	670	0.50	0.65
LPPI252008-100M	10.0	20	930	0.41	0.50

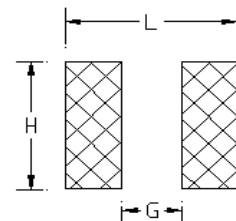
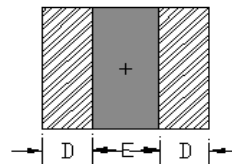
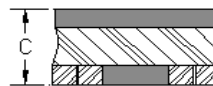
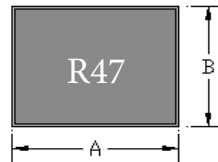

Notes:

- (1) Based on coil temperature rise ΔT approximately 40°C
- (2) L drops 30% from OCL typical

All test data based on 25°C ambient
 Part temperature (ambient + temperature rise) must not exceed 125°C under worst case operating conditions.
 Circuit design, components, PCB trace size, airflow and other cooling provisions all effect the part temperature.